

Lasermaschine Amada Ensis 3015 AJ 6kW + ASF 3015 EU

Baujahr 12/2018 – Installation 2019

Betriebsstunden: ca. 42.000h / 28.000h / 19.000h



Technische Daten:

Verfahrbereich: 3070 mm x 1550 mm
Tischbelastung: 920 kg
Positioniergeschwindigkeit: 170 m/min
Laserprinzip: Fliegende Optik
Maschinengewicht: 9.500 kg

Laserquelle:

Strahlquelle: Dioden gepumpter Faserlaser
Typ: AJ-6000
Laserleistung: 6000 Watt
Laserwellenlänge: 1,08 µm
Leistungsstabilität: +/- 2%
Pulsfrequenz: 1 – 10.000 Hz
Impuls-Tastverhältnis (Duty): 1-100%

Steuerung:

Typ: AMNC-3i
Bildschirm: 21,5" Touchscreen
Betriebssystem: Windows 7

Ausstattung:

NC-Fokus Kontrolle
Ölsprühfunktion
Sensorschneidkopf
Diodenlaser zur Positionierung
Schneidprozessüberwachung
Sicherheitseinrichtung
Automatischer Düsenwechsler
Förderband
WACS

Peripheriegeräte:

Transformator
Kühler
Absaugung

Maximale Materialstärken:

Normalstahl:	25 mm
Edelstahl:	25 mm
Aluminium:	25 mm
Messing:	15 mm
Kupfer:	12 mm



Be- und Entladesystem ASF 3015 EU, Bj.2019:



Technische Daten:

Max. Blechgrösse: 3.000 x 1.500 mm

Min. Blechgrösse: 1.500 x 1.000 mm

Materialstärke: 0.8 – 25 mm

Max. Materialgewicht: 920 kg

Min. Einzelteilgrösse: 180 x 180 mm

Max. Beladegewicht pro Fach: 3.000 kg

Stapelhöhe Rohmaterial: 80 mm

Stapelhöhe Entladepaletten: 220 mm

Anzahl Paletten: 2 x Schneidpaletten

7 x Rohmaterialpaletten

3 x Entladepaletten

Systemhöhe: 5.200 mm

Zeit für den Wechsel der Schneidpaletten: ungefähr 32 s

Blechladezykluszeit: ungefähr 88 s

Min. Schneidzeit (Stop Start): ungefähr 32 + 88 s

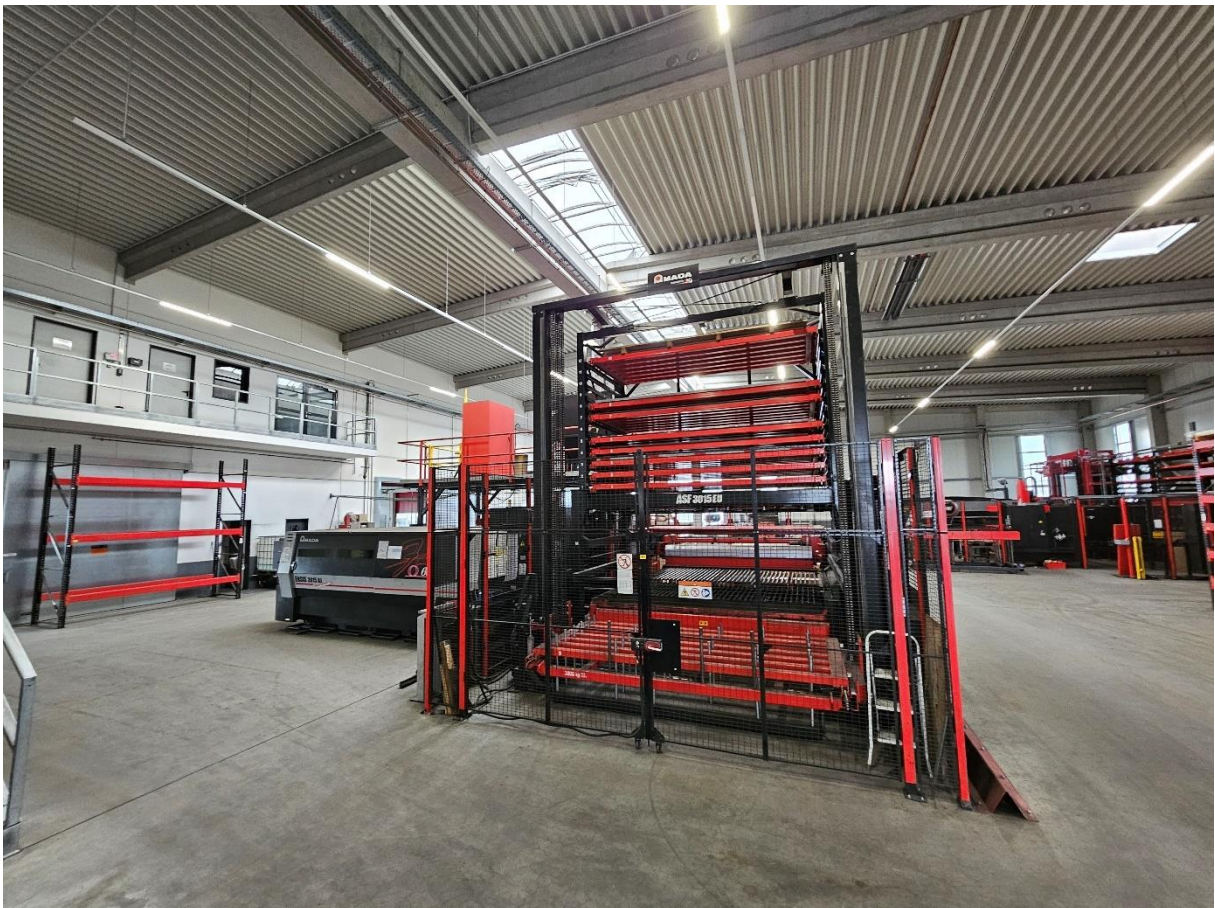



Specification ASF 3015 EU			
	Standard	Short	Tail
Pressing height ¹⁾	840mm	940mm	1040mm
Machine height ²⁾	5170mm	4450mm	6370mm
Sheet size max	3050 x 1525mm		
Sheet size min	1500 x 1000mm		
Sheet thickness	0.8 - 25.0mm ³⁾		
Sheet weight max	920kg		
Main part size w/o joint	180 x 180mm		
Main part size w/ joint	3000kg		
Cutting pallets	RM 7pcs LL 3pcs RM 80mm (220mm) ⁴⁾ LL 220mm	2pcs ¹⁾ 5pcs 5pcs 5pcs	5pcs 5pcs 5pcs
Pallets in tower 1	RM 7pcs LL 3pcs RM 80mm (220mm) ⁴⁾ LL 220mm	5pcs 5pcs 5pcs	5pcs
Stacking height	UL 120s ¹⁾ LL 88s ¹⁾		
Total cycle time		120s ¹⁾	
Time to prep. next sheet		88s ¹⁾	
Cutting pallet each. time		32s ¹⁾	
Second output station		Optional	
TK 3015 EU		Optional	

1. Please refer to laser perforations.
2. If positive Lifting, add 100mm to machine height.
3. If positive Lifting, add 100mm to machine height.
4. Minimum cutting time for no-laser continuous production
5. Minimum cutting time for no-laser continuous production

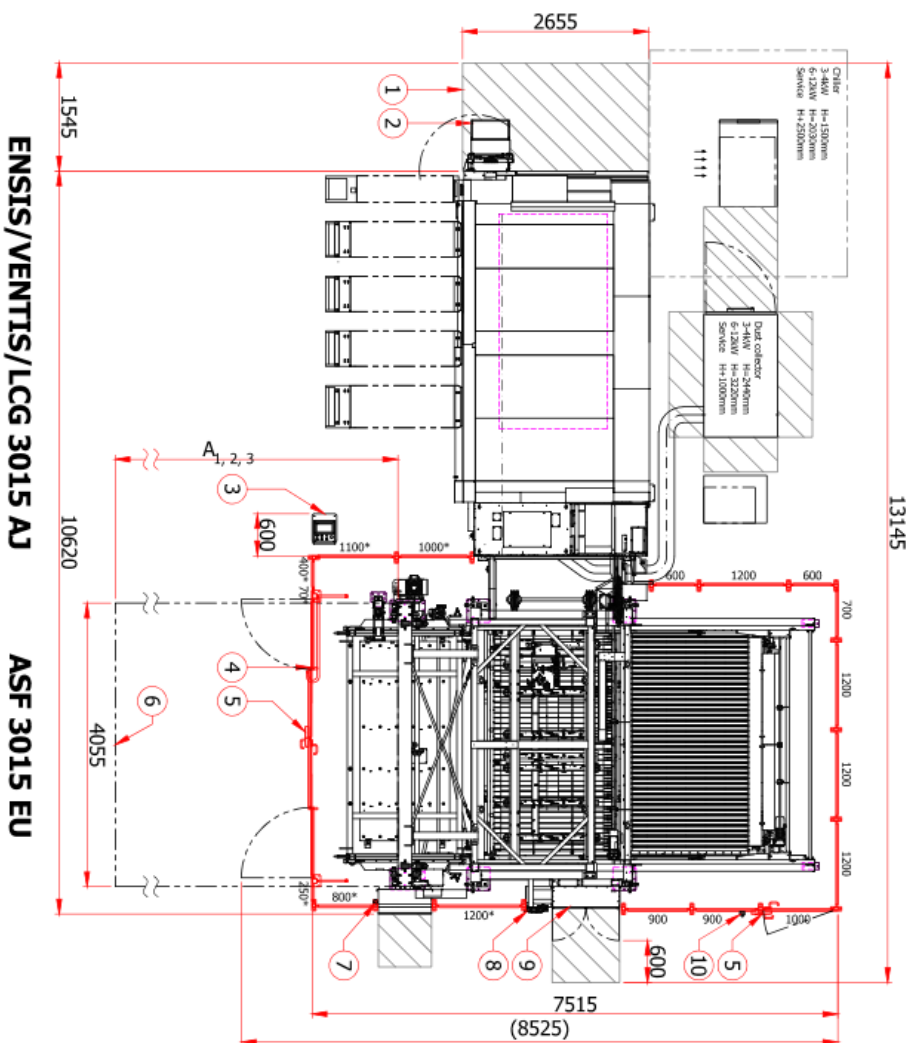

ENSIS/VENTIS/LCG 3015 AJ

ASF 3015 EU

- Notes:
1. Maintenance area
 2. CNC operator panel
 3. ASF EU operator panel, fixed to floor
 4. Hinged sliding door, W=4000mm, standard from #4177
 5. Safety switch, request for entrance
 6. Installation area for pallet elevator:
 - A₁ = 4220mm (Low version)
 - A₂ = 4940mm (Standard version)
 - A₃ = 6140mm (Tall version)
 7. Signal lamp with buzzer
 8. Air supply: 6bar, 800l/min normal (2000l/min temporarily)
 9. Power supply: 3x400V AC+N+PE / 32A
 10. Emergency stop button
- * Fence height = 2755mm

FOR DETAILED INSTALLATION INSTRUCTIONS, PLEASE REFER TO THE INSTALLATION MANUAL.
FOR DETAILED TECHNICAL SPECIFICATIONS, PLEASE REFER TO THE USER MANUAL.



Description	
Automation layout	ENSIS / VENTIS / LCG 3015 AJ +
ASF 3015 EU	

Page	Size	Drawn by	Modified by	Approved by
1(2)	A3	JBB	JBB	

Customer	Drawn date	Modified date	Approved date
7777	06.03.19	11.03.21	

Product	Scale	Drawing no	Revision
	1:50	A11447	4

ASF 3015 EU foot date: 330x630mm
 Max floor pressure, short version: F_{max}=0.64N/m² (2820Kg)
 Max floor pressure, standard version: F_{max}=0.88N/m² (3940Kg)
 Max floor pressure, tall version: F_{max}=1.18N/m² (5240Kg)
 Floor surface deviation max: ±1.0mm / 5000mm