

**Lasermachine Amada Ensis 3015 AJ 6kW + ASF 3015 EU**

Year 12/2018 – Installation 2019

Machine hours: about 42.000h / 28000h / 19000h



**Technical Data:**

Working range: 3070 mm x 1550 mm  
Table loading weight: 920 kg  
Positioning speed: 170 m/min  
Laser principle: Flying optic  
Machine weight: 9.500 kg

**Oscillator:**

Laser source: laser diode-pumped fiber laser  
Type: AJ-6000  
Laser power: 6000 Watt  
Laser wave length: 1,08  $\mu\text{m}$   
Stability: +/- 2%  
Pulse frequency: 1 – 10.000 Hz  
Duty range: 1-100%

**Control:**

Type: AMNC-3i  
Screen: 21,5" touchscreen  
Operating system: Windows 7

**Equipment:**

NC-focus control  
Oil spraying function  
Sensor cutting head  
Diode for positioning  
Cutting process monitoring  
Safety device  
Nozzle changer  
Conveyor belt  
WACS

**Peripheral devices:**

Transformator  
Cooling unit  
Dust collector

**Max. material thickness:**

Mild steel:	25 mm
Stainless steel:	25 mm
Aluminium:	25 mm
Brass:	15 mm
Copper:	12 mm



## Storage system ASF 3015 EU:



### **Technical Data:**

Max. sheet size: 3.000 x 1.500 mm

Min. sheet size: 1.500 x 1.000 mm

Sheet thickness: 0.8 – 25 mm

Max. sheet weight: 920 kg

Min. part size without joint: 180 x 180 mm

Max. load per pallet: 3.000 kg

Stack height raw material: 80 mm

Stack height product: 220 mm

Number of pallets: 2 x cutting pallets  
7 x raw material pallets  
3 x product pallets

System height: 5.200 mm

Cutting pallet exchange time: about 32 s

Sheet loading cycle time: about 88 s

Min. sheet cutting time (Stop Start): about 32 + 88 s

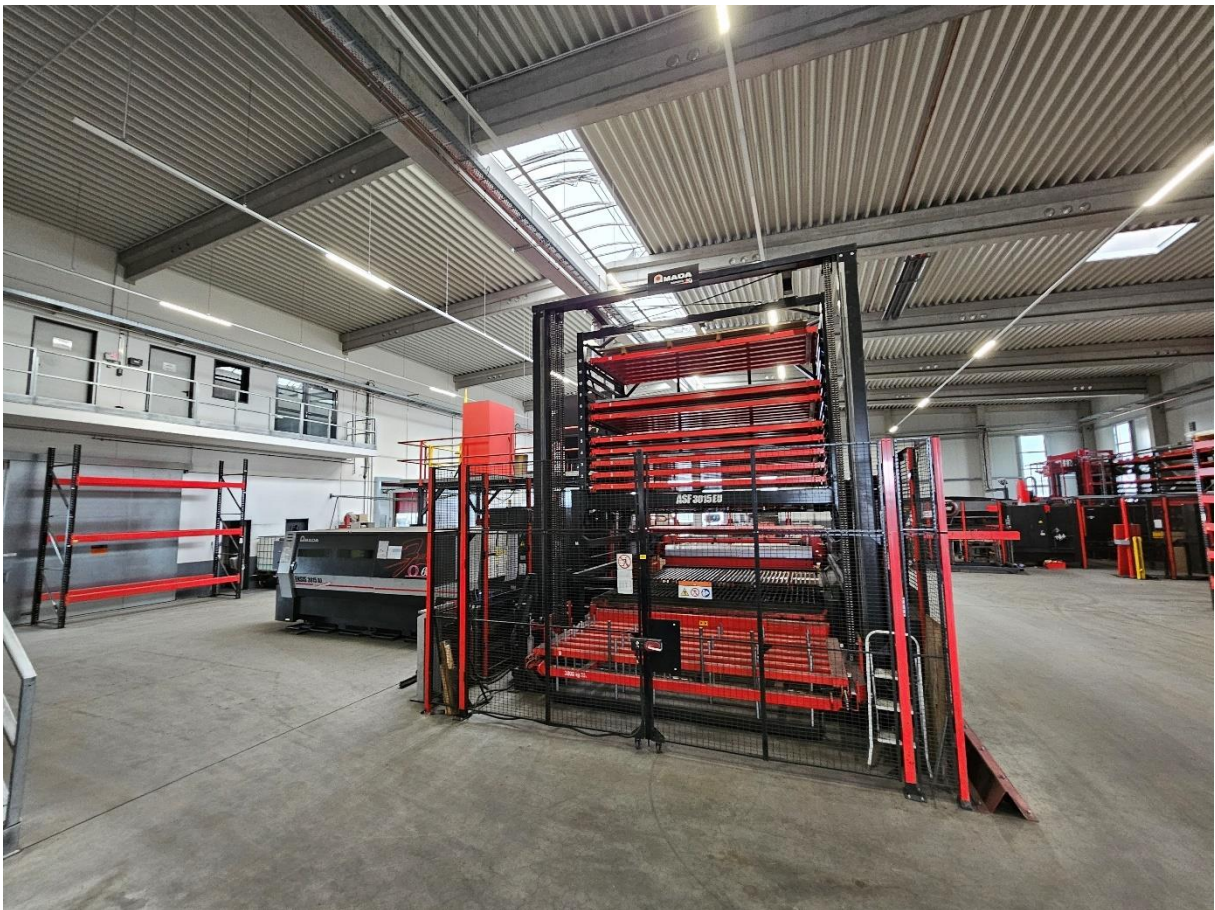



Specification ASF 3015 EU			
	Standard	Short	Tail
Pressing height <sup>1)</sup>	840mm	940mm	1040mm
Machine height <sup>2)</sup>	5170mm	4450mm	6370mm
Sheet size max	3050 x 1525mm		
Sheet size min	1500 x 1000mm		
Sheet thickness	0.8 - 25.0mm <sup>3)</sup>		
Sheet weight max	920kg		
Max part size w/o joint	180 x 180mm		
Max pallet load	3000kg		
Cutting pallets	RM	7pcs	2pcs <sup>4)</sup>
	UL	3pcs	2pcs
	RM	80mm (220mm) <sup>4)</sup>	
	UL	220mm	
Total cycle time	120s <sup>1)</sup>		
Time to prep. next sheet	88s <sup>1)</sup>		
Cutting pallet each. time	32s <sup>1)</sup>		
Second output station	Optional		
TK 3015 EU	Optional		

1. Please refer to laser perforations.
2. If positive lift/arms, add 100mm to machine height.
3. Max. sheet thickness.
4. Three cutting pallets & second output station included.
5. Minimum cutting time for no-laser continuous production.

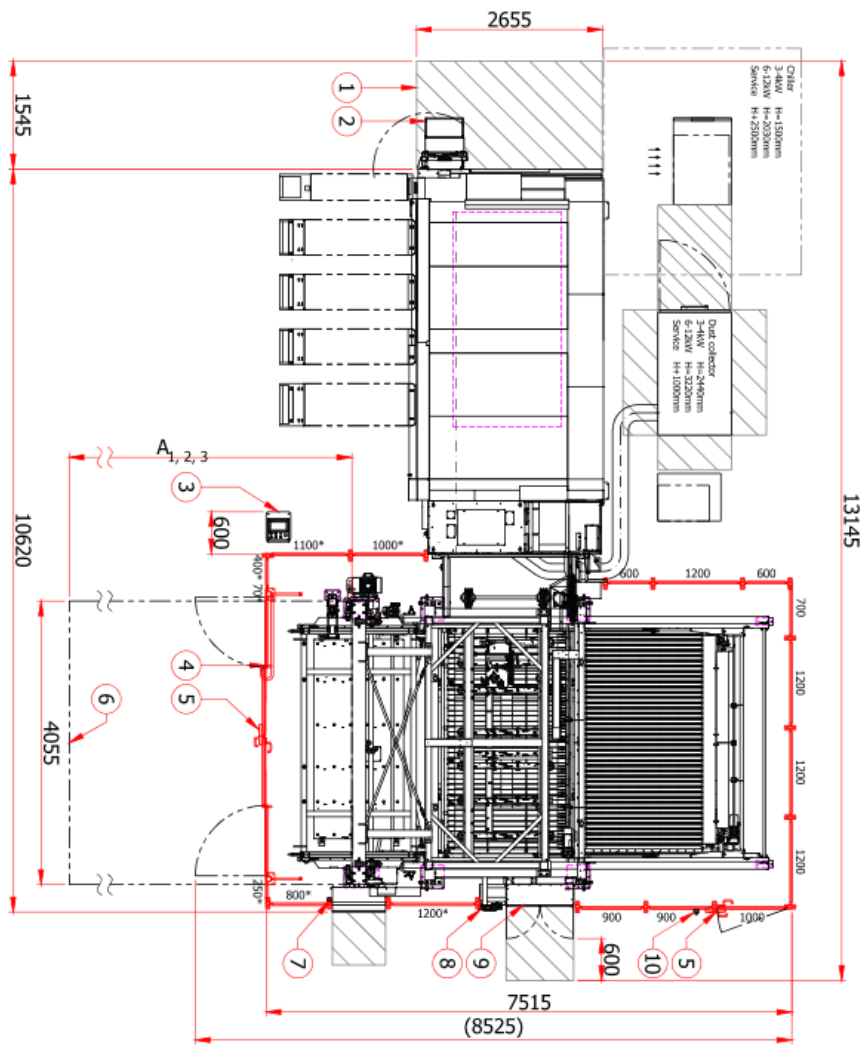

**ENSIS/VENTIS/LCG 3015 AJ ASF 3015 EU**

- Notes:
1. Maintenance area
  2. CNC operator panel
  3. ASF EU operator panel, fixed to floor
  4. Hinged sliding door, W=4000mm, standard from #4177
  5. Safety switch, request for entrance
  6. Installation area for pallet elevator:
    - A<sub>1</sub> = 4220mm (Low version)
    - A<sub>2</sub> = 4940mm (Standard version)
    - A<sub>3</sub> = 6140mm (Tall version)
  7. Signal lamp with buzzer
  8. Air supply: 6bar, 800l/min normal (2000l/min temporarily)
  9. Power supply: 3x400V AC+N+PE / 32A
  10. Emergency stop button
- \* Fence height = 2755mm

FOR DETAILED INSTALLATION INSTRUCTIONS, PLEASE REFER TO THE INSTALLATION MANUAL.  
FOR DETAILED TECHNICAL SPECIFICATIONS, PLEASE REFER TO THE USER MANUAL.

Automation layout  
ENSIS / VENTIS / LCG 3015 AJ +  
ASF 3015 EU

Page	1 (2)	Size	A3	Drawn by	JBB	Modified by	JBB	Approved by	
Customer		Drawn date	06.03.19	Modified date	11.03.21	Approved date			
Product		Scale	1:50	Drawing no	A11447	Revision			4

ASF 3015 EU foot date: 330x630mm  
 Max floor pressure, short version: F<sub>max</sub>=0.64N/m<sup>2</sup> (28200kg)  
 Max floor pressure, standard version: F<sub>max</sub>=0.88N/m<sup>2</sup> (38400kg)  
 Max floor pressure, tall version: F<sub>max</sub>=1.18N/m<sup>2</sup> (52400kg)  
 Floor surface deviation max: ±1.0mm / 5000mm